

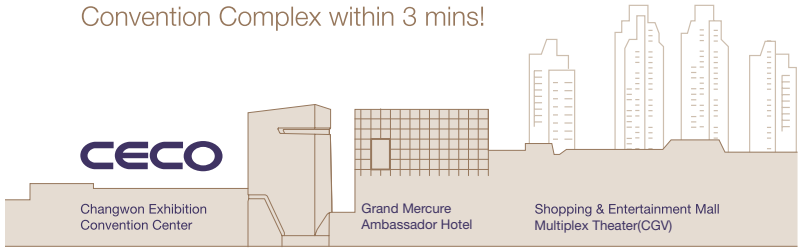

창원컨벤션센터 | Changwon Exhibition Convention Center

## ALL-INCLUSIVE SERVICE

Convention Complex within 3 mins!



### Grand Mercure Ambassador Hotel

Gallery and Boutique Hotel with Notable Artwork

- 321 Rooms / 18 ground floors and 3 underground floors
- Fully prepared facilities such as Banquet hall, Fitness center, Restaurants, Business center, etc.
- Connecting to CECO with a bridge, 1 minute walking distance

### Shopping · Entertainment Mall

Various events and shopping malls

- 150 Shops
- Restaurants, Fashion outlets, Supermarket(Lotte Mart), Multiplex theater(CGV)
- Sky garden center, Café on the rooftop and Art exhibition
- Clinics, Bank, Offices, etc.
- Connecting to CECO with a bridge, 3 minutes walking distance

## Accommodations

864 Accommodations with 18,805 Rooms in Changwon



**1 minutes**  
Connect to CECO

**Total 321 Rooms**

**Grand Mercure  
Ambassador  
Changwon**  
(321 Rooms)

**5~10 minutes**  
by car

**Total 1,062 Rooms**

**M-STAY Hotel**  
(357 Rooms)

**Changwon Hotel**  
(173 Rooms)

**Hotel International**  
(121 Rooms)

**Canberra Hotel**  
(88 Rooms)

**Olympic Hotel**  
(86 Rooms)

**Best Louis Hamilton Hotel**  
(70 Rooms)

**Sungsan Hotel**  
(63 Rooms)

**Hotel Avenue**  
(60 Rooms)

**Crown Hotel**  
(60 Rooms)

**Toyoko-inn**  
(415 Rooms-Opening on 2020)

**20 minutes**  
by car

**Total 249 Rooms**

**Savoy Hotel  
Changwon**  
(59 Rooms)

**Masan Tourist  
Hotel**  
(56 Rooms)

**Arirang Hotel**  
(48 Rooms)

**Masan M Hotel**  
(46 Rooms)

**Soleum Hotel**  
(40 Rooms)

**40 minutes**  
by car

**Total 522 Rooms**

**Eden Valley  
Resort**  
(255 Rooms)

**I Square Hotel**  
(181 Rooms)

**Lake Hills  
Bugok Resort**  
(86 Rooms)

## Gyeongnam, Changwon

- Industrial and Environmental Hub in Asia
- International Convention City



### Strategic Location

- Production Base for global companies such as Samsung, LG, Doosan, etc.
- High Accessibility

### Industrial Infrastructure

- Cradle of high value-added manufacturing companies including Machinery, Heavy industry, Shipbuilding, Aerospace and Robotics in Korea
- Complex of global companies such as Samsung, LG, Doosan, GM and Volvo
- Matching Technical Tours related to Convention and Exhibition

### Eco-City

- No.1 for the ratio of green space in Korea
- Various theme parks, Bicycle campaigns, Ecological river projects
- Holding Ramsar Convention and UNCCD(UN Convention to Combat Desertification)

### Attractive Tourism

CNN has chosen 50 Must-see Attractions in Korea, and, among them, you can enjoy 9 places as followed.

1. Namhae Gacheon Darengyi Village (3rd)
2. Jinhae Gyeonghwa Station (5th)
3. Changyeong Upo Wetland (6th)
4. Hapcheon Haeinsa Temple (13th)
5. Cheonwangbong Peak of Mt. Jiri (14th)
6. Yeojwacheon Cherry Blossom Walkway (17th)
7. Hamyang Terraced Paddy Field(Rice Paddy terrace) (29th)
8. Sancheong Mt. Hwangmae Royal Azalea Festival (34th)
9. Jinju Chokseoknu Pavilion (49th)



## TRANSPORTATION

### ✈ Air Transportation

Incheon Int'l Airport, Gimpo Int'l Airport ~ Gimhae Int'l Airport (1hr)  
\* Gimhae Int'l Airport ~ Changwon (36km, 40min by limousine bus)

### 🚆 High Speed Train **KTX**

Seoul Station ~ Changwon Station, Changwon Central Station, Masan Station (2hr 40min)  
Changwon Station, Changwon Central Station ~ CECO (5~6km / 10~15min by car)  
Masan Station ~ CECO (10km / 20min by car)

- **KTX Reservation Information**  
TEL.+82-1544-7788  
www.letsrail.com

### 🚌 Express Bus

Seoul (Gangnam Express Terminal, East Seoul Bus Terminal) ~ Changwon Bus Terminal (4hr)  
Changwon Bus Terminal ~ CECO (2.5km / 5min by car)

- **Changwon Bus Terminal Reservation Information**  
TEL.+82-1688-0882  
www.kobus.co.kr (Changwon Express Bus)  
www.changwonbus.com (Changwon Intercity Bus)

### 🚶 City Bus

17, 102, 103, 109, 113, 155, 212, 220, 221, 506, 751



**CECO**

362 Wonidaero, Uichang-gu, Changwon, Gyeongnam, 51408, Korea  
www.ceco.co.kr

Total Area : 39,817㎡

Architectural Area : 78,929㎡

Exhibition Area

- Indoor Exhibition Hall : 9,375㎡

- Outdoor Exhibition Area : 3,615㎡

Conference Area

- Convention Hall : 1,653㎡ (Convention Hall Lobby : 1,090㎡ )

- Conference Room : 2,091㎡ (16 Rooms)

Parking Space : 915 cars



Outdoor Exhibition Area(1F)

OVERVIEW OF FACILITIES

Outdoor Exhibition Area

CECO's Outdoor Exhibition Area is the best place for special events such as cultural events and market, etc.

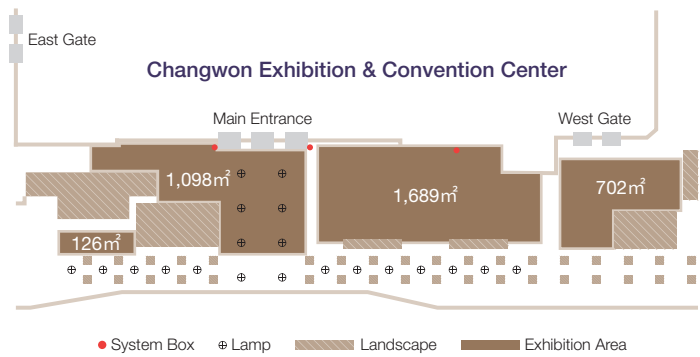

1F

Size

3,615㎡

Facilities

Electric power supply(3 System Boxes), Water/Drainage

Floor Load

1ton/㎡

Floor Finishing Material

Marble

Exhibition Hall

CECO's Exhibition Hall is a multi-functional column-free hall which optimizes its use for various events such as exhibitions, trade shows, international conventions, banquets or concerts.

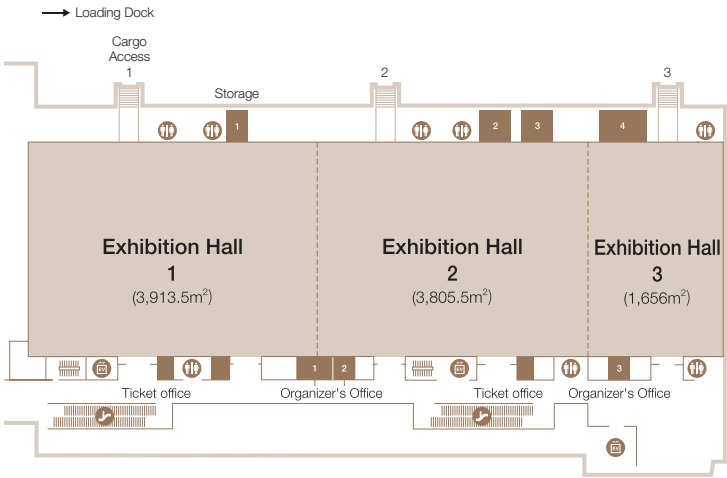

3F

Size

9,375㎡, 2 or 3 Separable Halls (1,656㎡ to 9,375㎡)

Ceiling Height

9.5~16m

Capacity

500 Exhibition booths (Standard 3x3m booth) • 8,000 persons (Theater Type)

Facilities

Organizer's office (3 locations), Storage (4 locations), Ticket Office (2 locations), 57 Floor Boxes

Convention Hall

The Convention Hall is equipped with Laser Projector and professional A/V system. It is perfect for international conventions, banquets and culture events.

It is also an independent place that has spacious lobby with nice view that you can utilize the space for the luxurious cocktail reception and small exhibition.

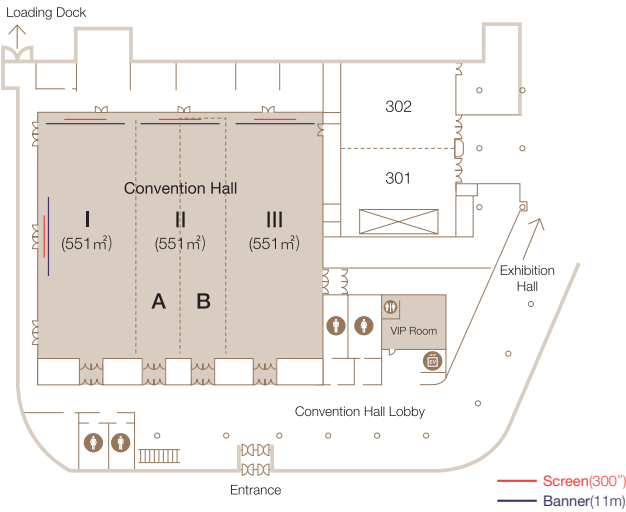

3F

Size

1,653㎡ (43.5m X 38m), 2 or 3 Seperable Halls (551㎡ to 1,653㎡)

Ceiling Height

8m

Capacity

1,500 persons / 550 persons Each Hall

Facilities

Laser Projectors, Lobby (1,090㎡), VIP Room, Preparation Room, Simultaneous Interpretation System (8 languages), Cloak Room

3F

Size

480㎡ (26.8m X 17.9m), 2 Separable rooms (240㎡ to 480㎡)

Ceiling Height

6m

Capacity

416 persons(Theater type), 156 persons(Room301) / 208 persons(Room302)

Facilities

Simultaneous Interpretation System (6 languages), LCD Projector(Each Room), Fixed Stage(Room 301, 13 X 3.8m)

Conference Rooms

CECO has 16 Conference Rooms that are highly flexible for a variety of events such as international conferences, symposiums, seminars or lectures. It provides high quality of service by customizing facilities according to the purpose of events.

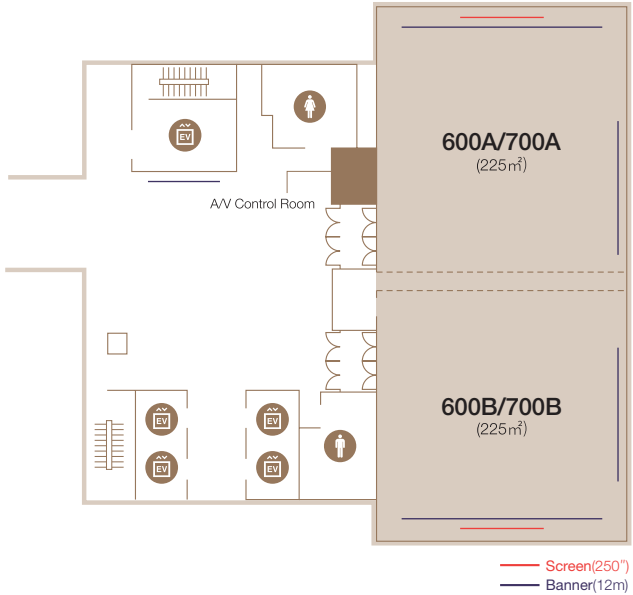

6/7F

Size

480㎡ (15m X 32m), 2 Separable rooms (225㎡ to 480㎡)

Ceiling Height

6m

Capacity

440 persons(Theater type) / 160 persons(Each hall, Theater type)

Facilities

LCD Projectors, Motorized Screens (Each Room)

6F

Size

651㎡, 7 Separable Rooms (80㎡ to 443㎡)

Ceiling Height

3m

Capacity

70~420 persons

Facilities

LCD Projectors, Motorized Screens(Each Room)

Room	Net area (m)	Architectural Area (㎡)	Ceiling Height (m)	Capacity		
				Theater	Class	Banquet
601	9.5 X 8.5	85	3	70	40	40
602	13.5 X 8.5	123		120	72	60
603	9.0 X 8.5	80		70	40	40
604	9.0 X 8.5	80		70	40	40
605	9.0 X 8.5	80		70	40	40
606	9.0 X 8.5	80		70	40	40
607	13.5 X 8.5	123		120	72	60
601+602 606+607	23.0 X 8.5	208	3	216	120	100
603~607	49.5 X 8.5	443		420	240	200